

REV	DESCRIPTION	NAME	DATE
	INIT.	M.D	12/94

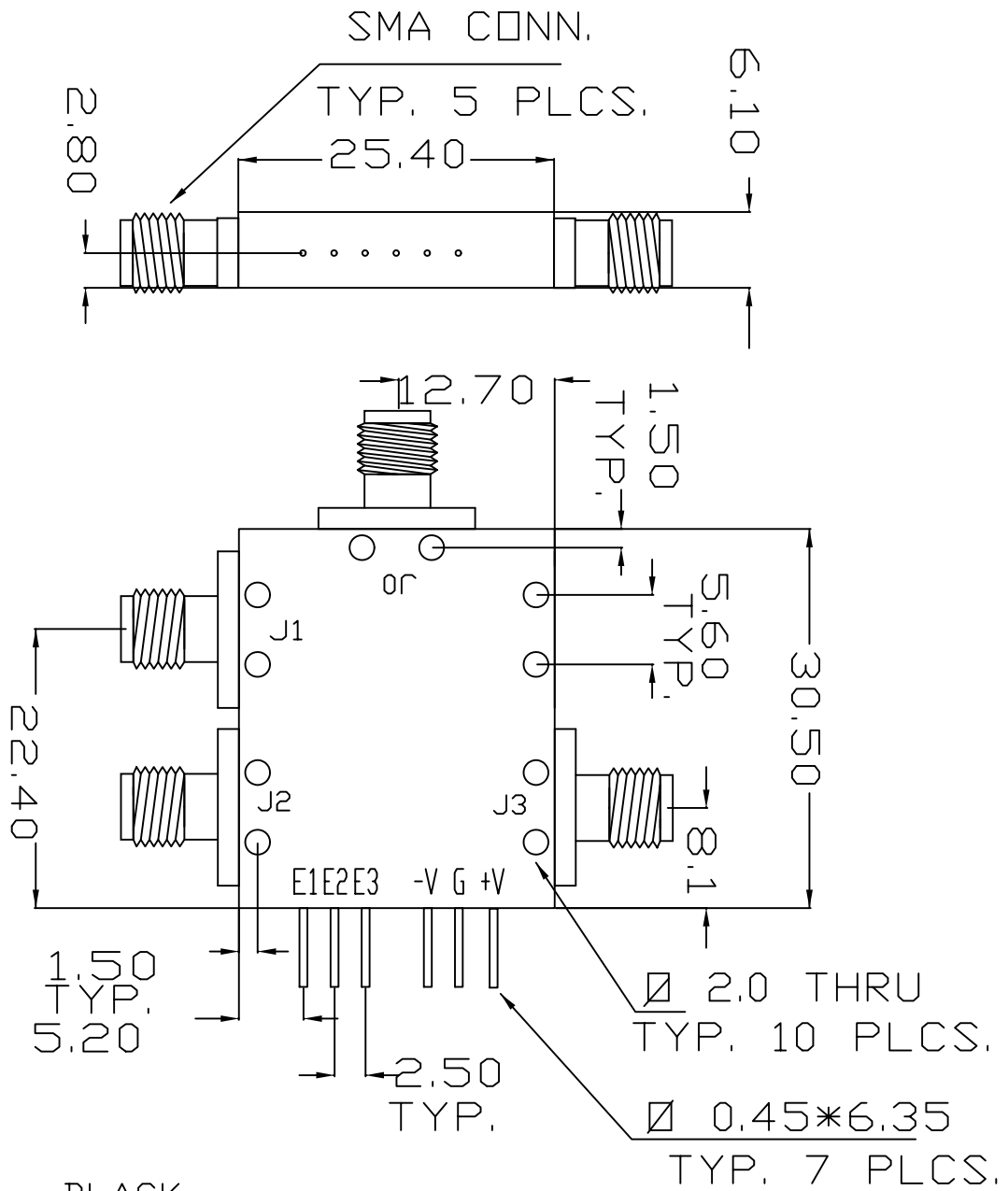

MARKING - BLACK

GENERAL TOLERANCE : ± 0.3

NEXT ASSEMBLY		FINISH	GOLD	NAME	DATE
		PLATING PER		DRAWN	M.D 12/94
		PAINTING PER		ENG APP'D	A.C 12/94
		MATERIAL	AL-6061-T6	QA. APP'D	M.C 12/94
		SUREFACE FINISH			
		GENERAL TOLERANCES		TITLE	
DIM	MM/INCH	.X $\pm .10 / .010$ "		SP3T SWITCH	
		.XX $\pm .05 / .005$ "		PC: 202	
SCALE		.XXX $\pm .025 / .002$ "			
EYAL MICROWAVE INDUSTRY				DRAWING NO.	R-57
				REV.	

Ø2.26Thru for NC-4-40x6.35 Deep
 On mounting surface located
 on 25.4mm circle/2 Places

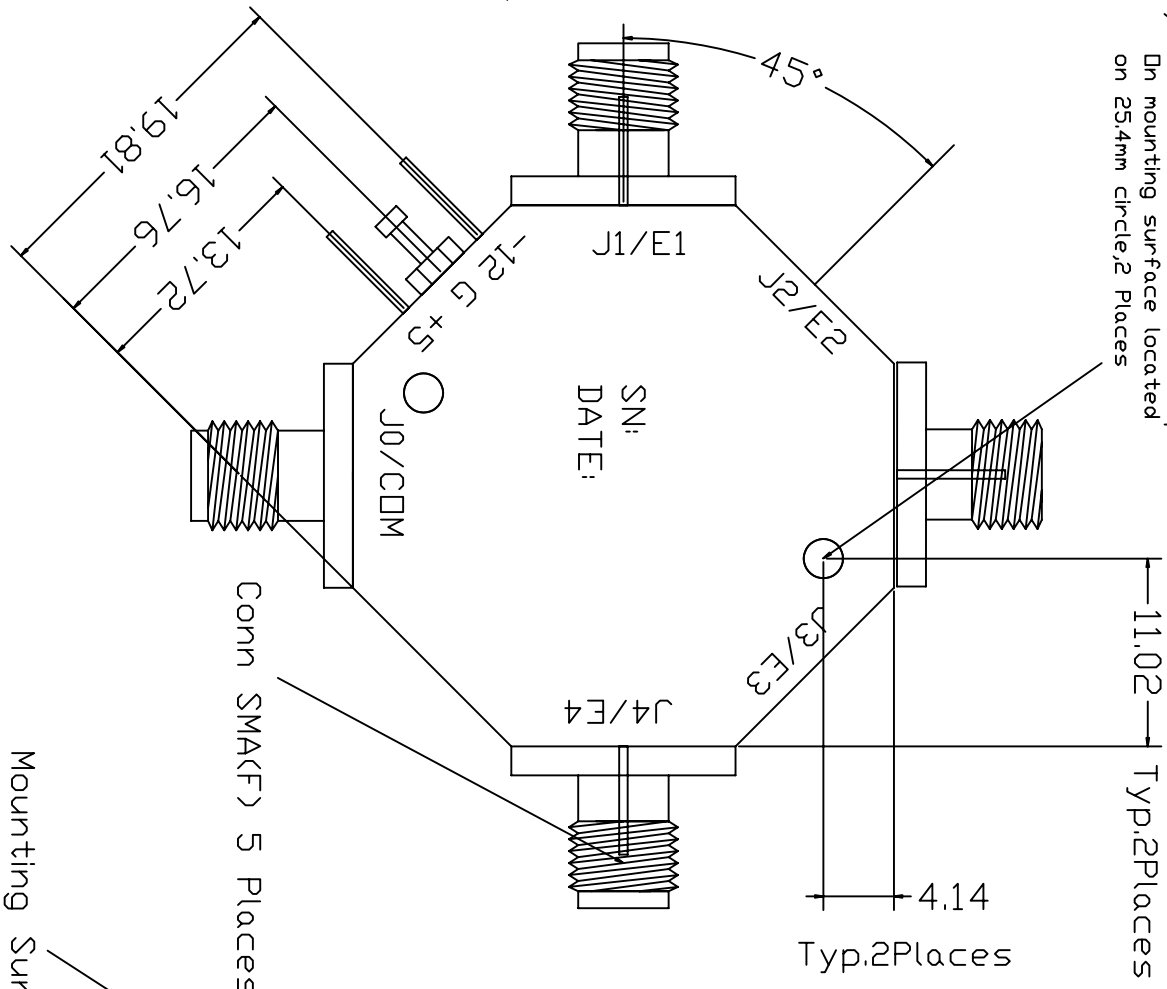

3.18
 1.91

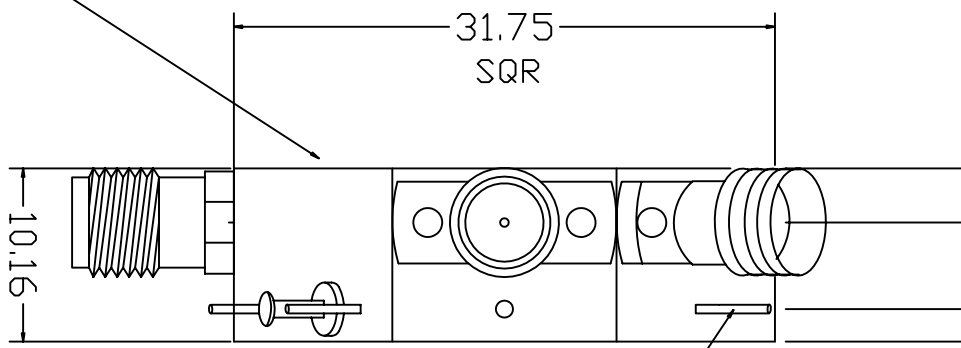

REV	DESCRIPTION	NAME	DATE
---	INIT	S.V	07/07/2

reference only
 peals not symbol of ports & control
 pleas note switch reflective
 pleas note 4 SMA f connectors

EWAL MICROWAVE
 AND
 SK-5416

FINISH	Gold	NAME	S.V	DATE	07/07/2
PAINING PER		ENG APP'D	A.C	07/07/2	
MATERIAL	AL-6061-T6	QA APP'D	M.C	07/07/2	
SURFACE FINISH	V _{PSL}				
GENERAL TOLERANCES ± 0.3					

DIM	MM
SCALE	

EWAL MICROWAVE INDUSTRY
 DRAWING NO.
 TITLE OUTLINE FOR SP3T N,Ref Switch
 REV.

REV	DESCRIPTION	NAME	DATE
INIT.		M.D	14/8/94

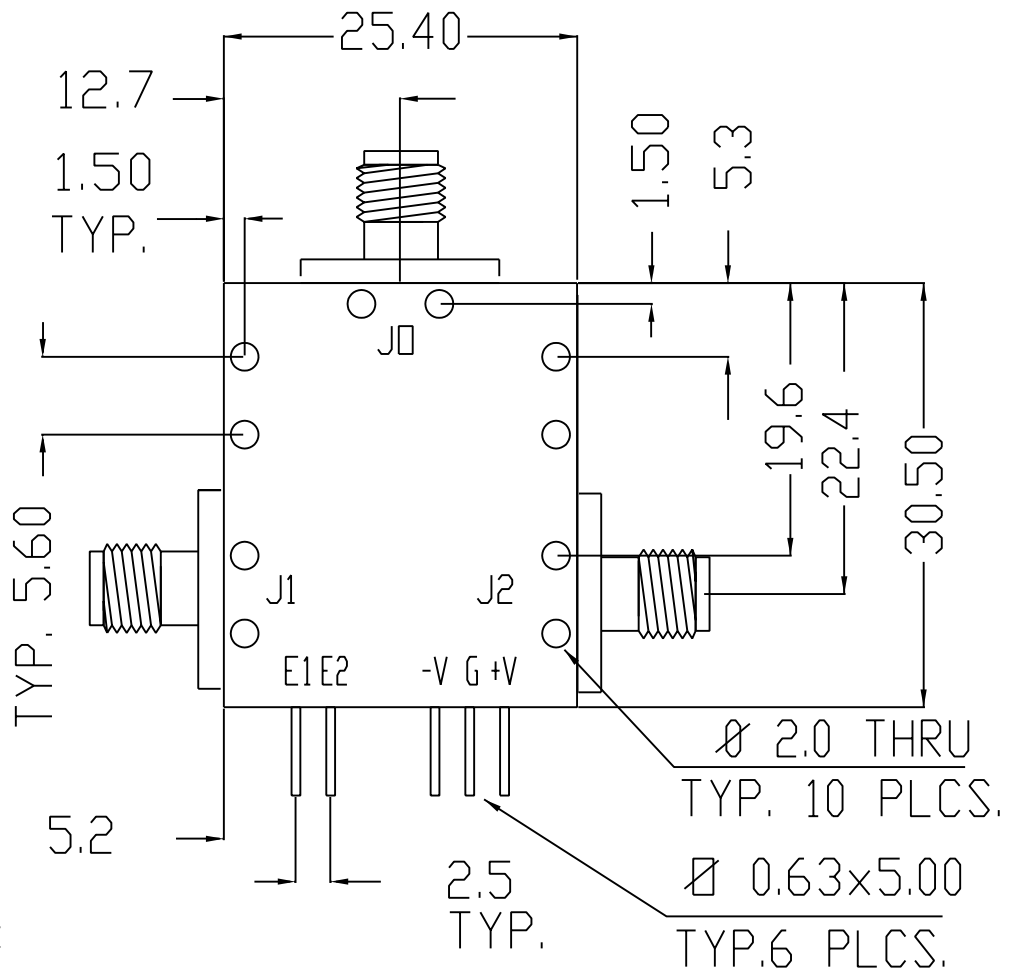
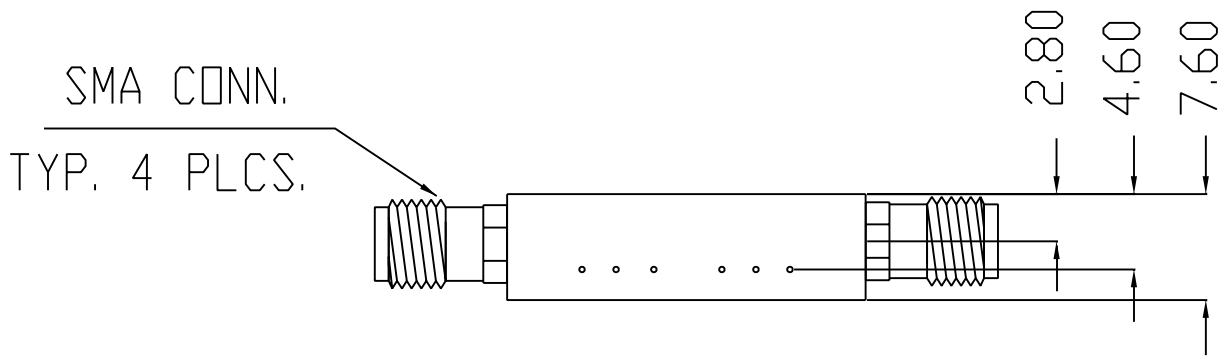

MARKING - WHITE

GENERAL TOLERANCE ± 0.5

NEXT ASSEMBLY		FINISH	BLACK EPOXY	NAME	DATE
		PLATING PER		DRAWN	M.D 14/8/94
		PAINTING PER		ENG APP'D	A.K 14/8/94
		MATERIAL	AL-6061-T6	QA. APP'D	M.C 14/8/94
		SUREFACE FINISH			
		GENERAL TOLERANCES		TITLE	
DIM	MM/INCH	.X $\pm .10 / .010$ "		SP2T SWITCH	
		.XX $\pm .05 / .005$ "		P.C 502	
SCALE		.XXX $\pm .025 / .002$ "			
EYAL MICROWAVE INDUSTRY		DRAWING NO. R-4			REV.

REV	DESCRIPTION	NAME	DATE
INIT.		M.D	14/8/94

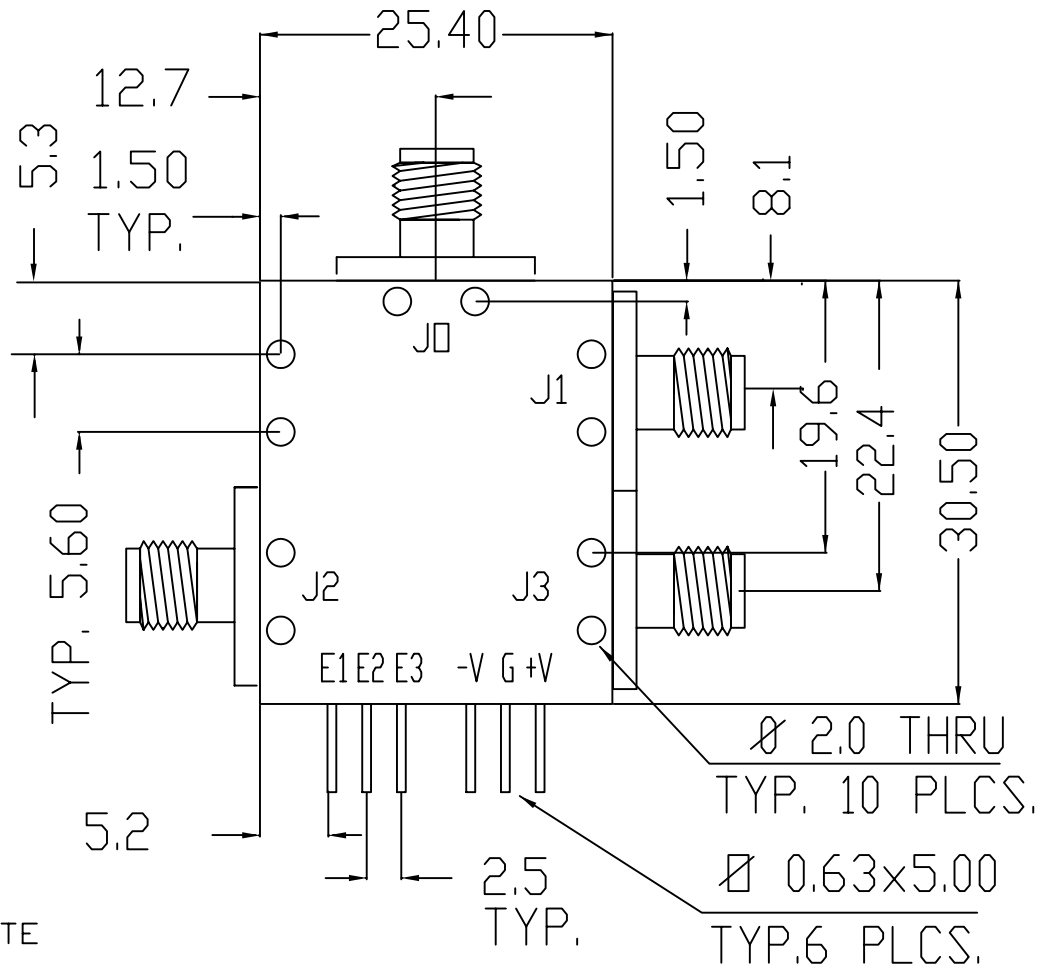
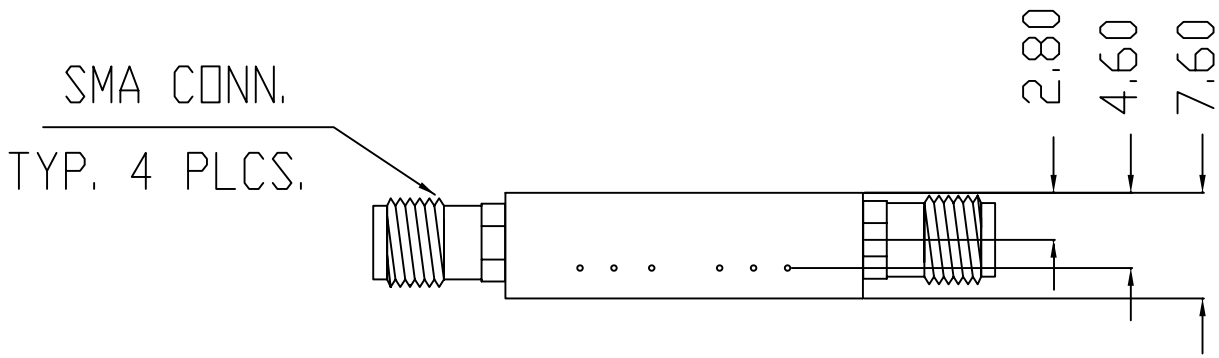

MARKING - WHITE

GENERAL TOLERANCE \pm 0.5

NEXT ASSEMBLY		FINISH	BLACK EPOXY	NAME	DATE
		PLATING PER		DRAWN	M.D 14/8/94
		PAINTING PER		ENG APP'D	A.K 14/8/94
		MATERIAL	AL-6061-T6	QA. APP'D	M.C 14/8/94
		SUREFACE FINISH			
		GENERAL TOLERANCES		TITLE	
DIM	MM/INCH	* \pm .10 / .010"		SP3T SWITCH	
SCALE		.XX \pm .05 / .005"		P.C 502	
		.XXX \pm .025 / .002"		J1=opposite	
EYAL MICROWAVE INDUSTRY			DRAWING NO.	R-4	REV.

REV	DESCRIPTION	NAME	DATE
	INIT.	M.D	6/4/00

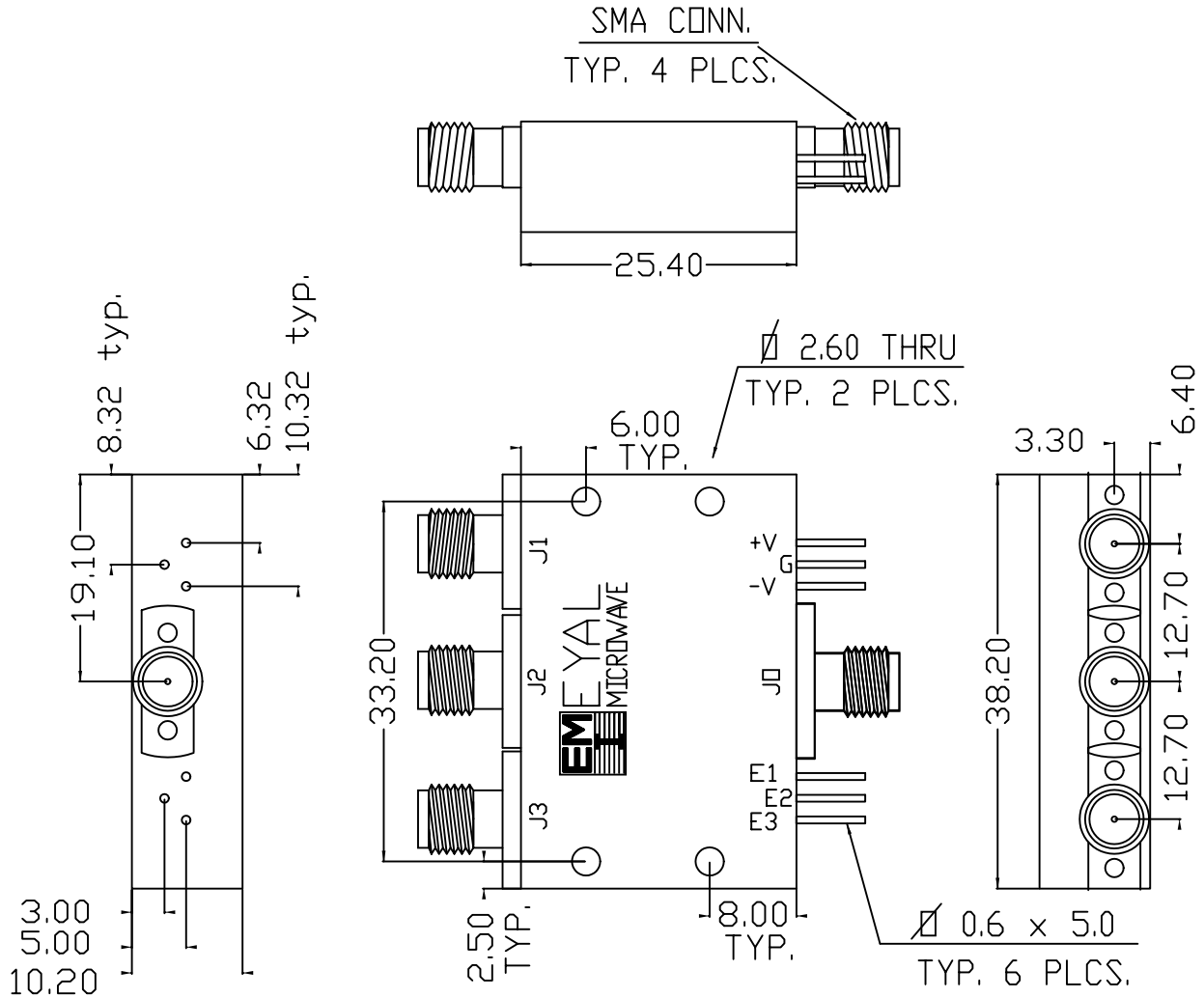

NOTES:

1) MARKING - WHITE

EYAL MICROWAVE IND?????? ????\$??e\$ SK-4658

NOTES:		FINISH	BLACK EPOXY.	NAME	DATE
		PLATING PER		DRAWN	M.D 6/4/00
		PAINTING PER		ENG APP'D	A.C 6/4/00
		MATERIAL	AL-6061-T6	QA. APP'D	M.C 6/4/00
		SUREFACE FINISH			
		GENERAL TOLERANCES		TITLE OUTLINE FOR SP3T SWITCH	
DIM	MM	± 0.5mm		P.C: 502/10	
SCALE				WIDTH OPT. : 10.2 mm	
			DRAWING NO.		REV.
			502/10		OPT.

REV	DESCRIPTION	NAME	DATE

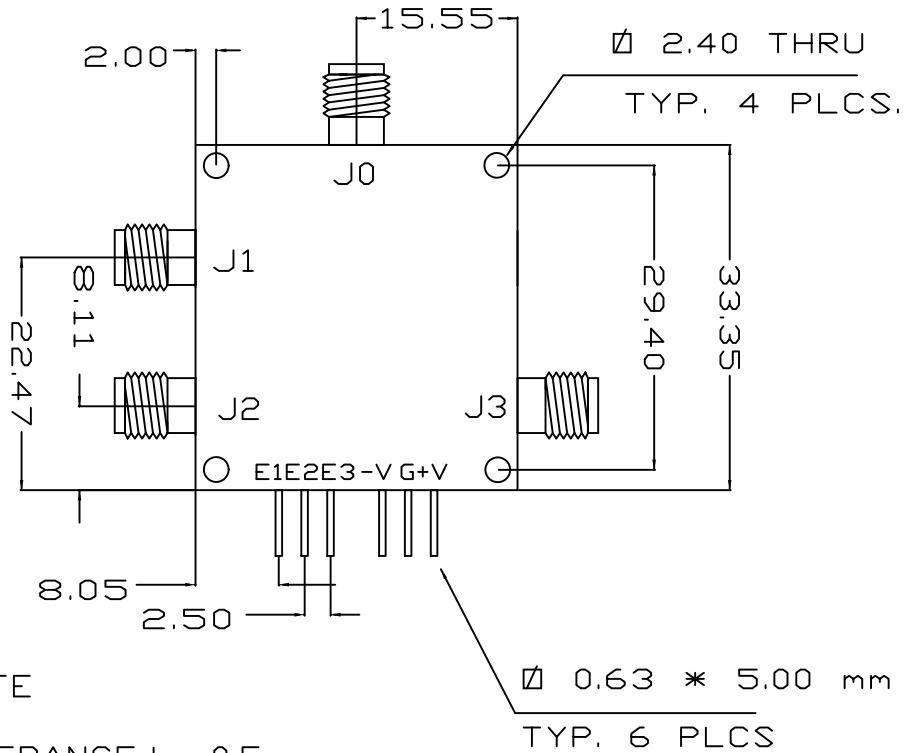
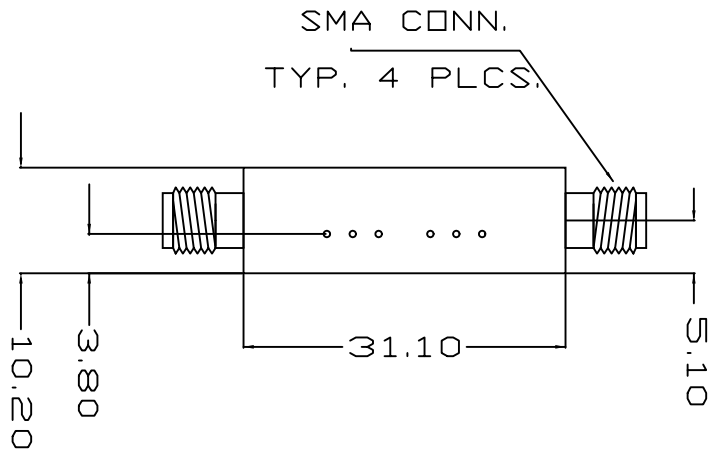

MARKING WHITE

GENERAL TOLERANCE +_ 0.5

NEXT ASSEMBLY		FINISH	BLACK EPOXY	NAME	DATE
		PLATING PER		DRAWN	M.D 14/8/94
		PAINTING PER		ENG APP'D	A.C 14/8/94
		MATERIAL	AL-6061-T6	QA. APP'D	M.C 14/8/94
		SUREFACE FINISH			
		GENERAL TOLERANCES		TITLE	
DIM	MM/INCH	.* ±.10 / .010"		SP3T SWITCH	
		.XX ±.05 / .005"		P.C 402	
SCALE		.XXX ±.025 / .002"		DRAWING NO. R-22	
EYAL MICROWAVE INDUSTRY				REV.	

REV	DESCRIPTION	NAME	DATE
INIT.		M.D	14/8/94

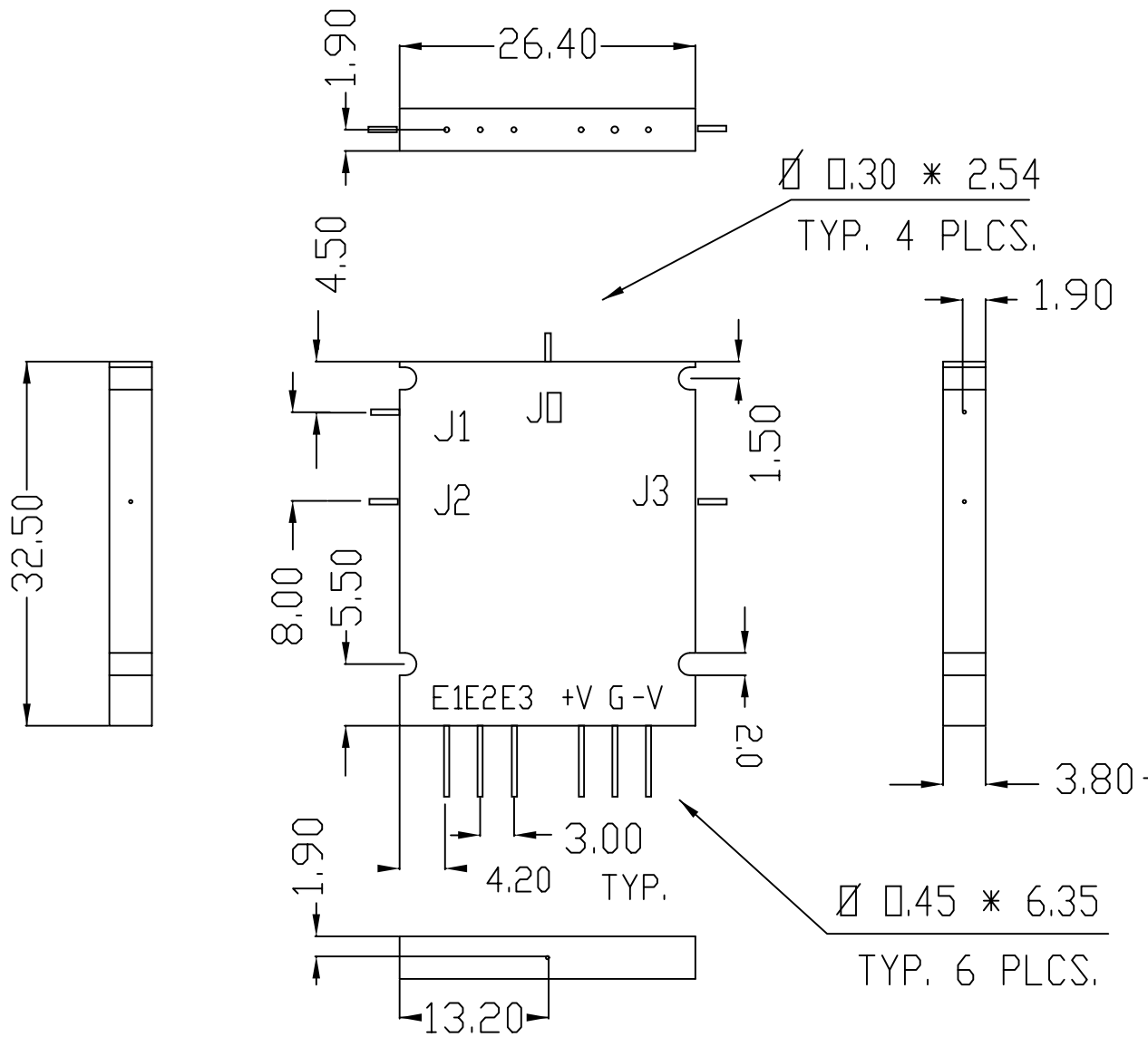

GENERAL TOLERANCE ± 0.3

MARKING - BLACK

NEXT ASSEMBLY		FINISH	GOLD	NAME	DATE
		PLATING PER	MIL-G-45204	M.D	14/8/94
		PAINTING PER		A.C	14/8/94
		MATERIAL	AL-6061-T6	M.C	14/8/94
		SUREFACE FINISH			
		GENERAL TOLERANCES		TITLE	
DIM	MM/INCH	.X $\pm .10 / .010$ "		SP3T DROP-IN SWITCH P.C 302-3	
SCALE		.XX $\pm .05 / .005$ "			
		.XXX $\pm .025 / .002$ "			
EYAL MICROWAVE INDUSTRY			DRAWING NO.	R-18	REV.

REV	DESCRIPTION	NAME	DATE
INIT.		M.D	14/8/94

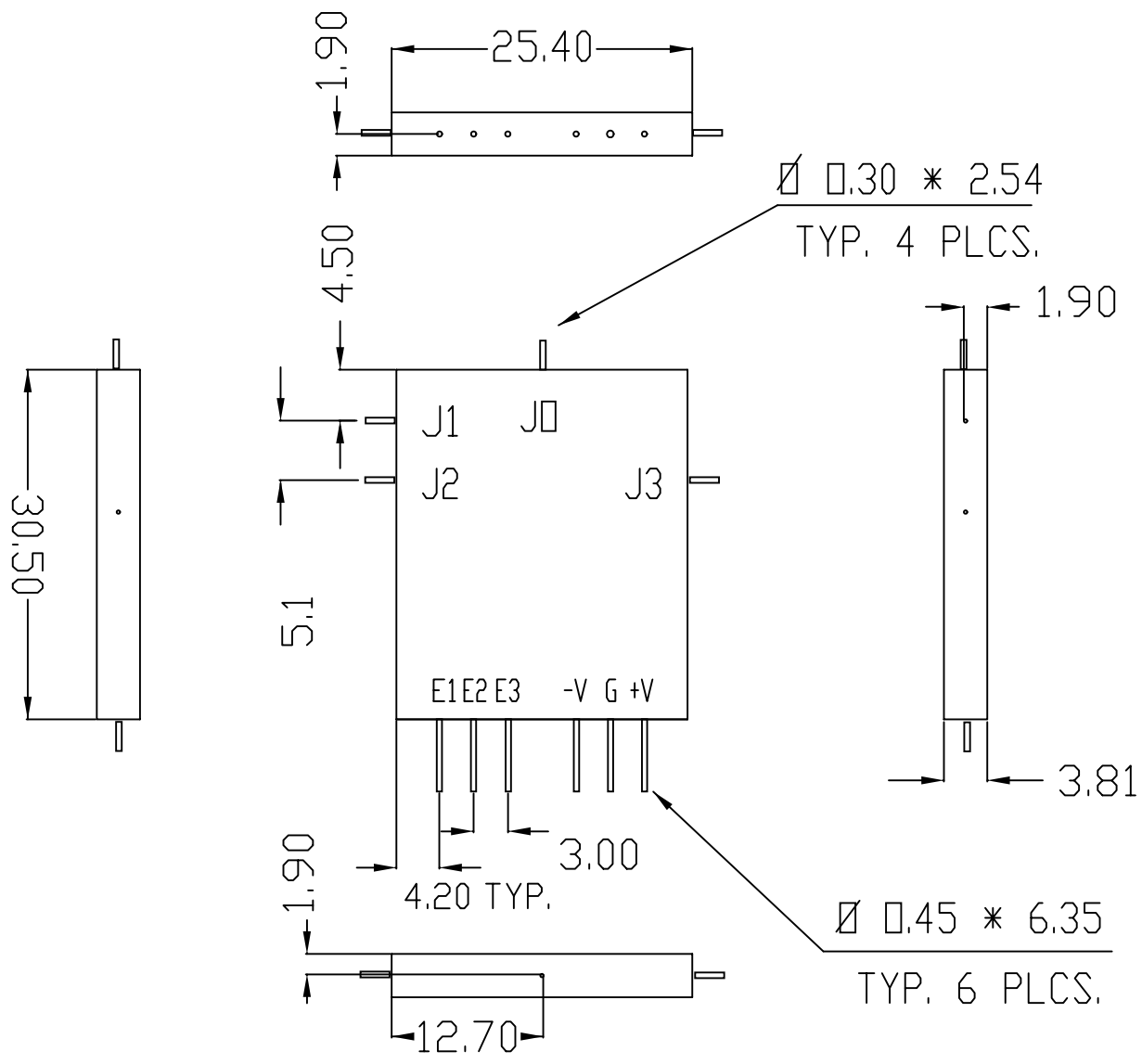

GENERAL TOLERANCE ± 0.3
 MARKING - BLACK

NEXT ASSEMBLY		FINISH	GOLD	NAME	DATE
		PLATING PER	MIL-G-45204	DRAWN	M.D 14/8/94
		PAINTING PER		ENG APP'D	A.C 14/8/94
		MATERIAL	AL-6061-T6	QA. APP'D	M.C 14/8/94
		SUREFACE FINISH			
		GENERAL TOLERANCES		TITLE	
DIM	MM/INCH	.X $\pm .10 / .010$ "		SP3T DROP-IN SWITCH P.C 302-1	
SCALE		.XX $\pm .05 / .005$ "			
		.XXX $\pm .025 / .002$ "			
EYAL MICROWAVE INDUSTRY			DRAWING NO.	R-21	REV.

REV	DESCRIPTION	NAME	DATE
	INIT.	M.D	12/94

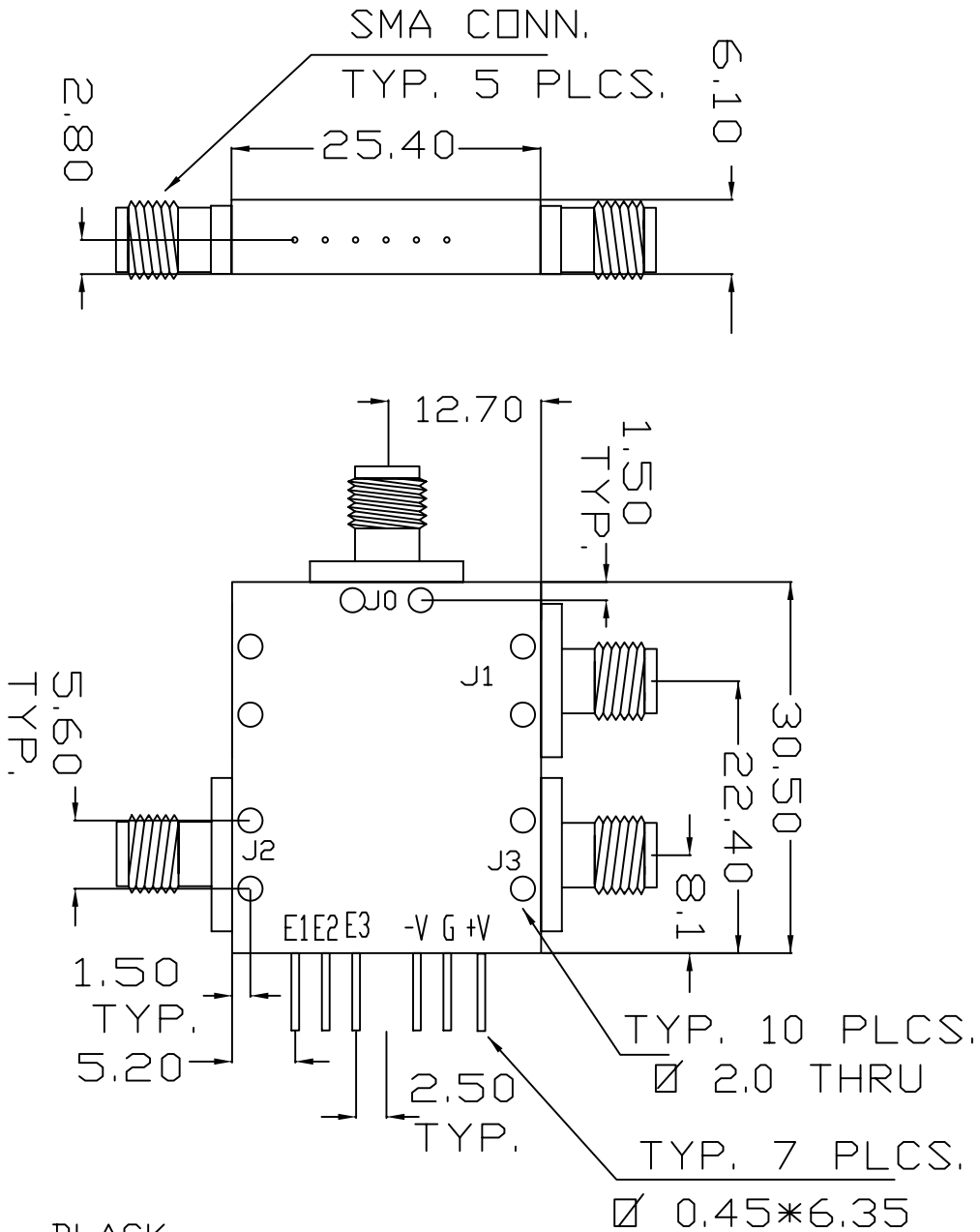

NEXT ASSEMBLY		FINISH	GOLD	NAME	DATE
		PLATING PER		DRAWN	M.D 12/94
		PAINTING PER		ENG APP'D	A.C 12/94
		MATERIAL	AL-6061-T6	QA. APP'D	M.C 12/94
		SUREFACE FINISH			
		GENERAL TOLERANCES		TITLE	
DIM	MM/INCH	.X $\pm .10 / .010$ "		SP3T SWITCH	
SCALE		.XX $\pm .05 / .005$ "		PC: 202--J1--□ppo	
		.XXX $\pm .025 / .002$ "		DRAWING NO.	
EYAL MICROWAVE INDUSTRY				REV.	