

REV	DESCRIPTION	NAME	DATE
	INIT.	A.C	27/11/94

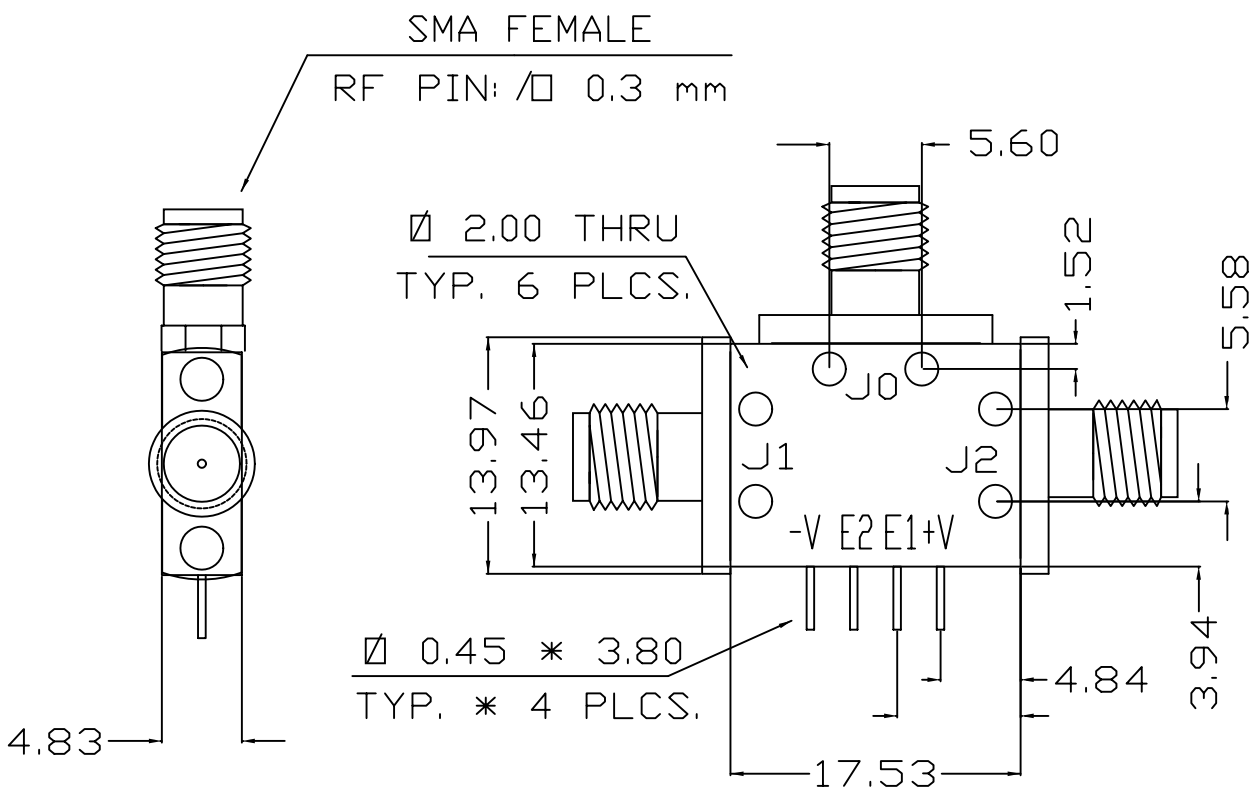
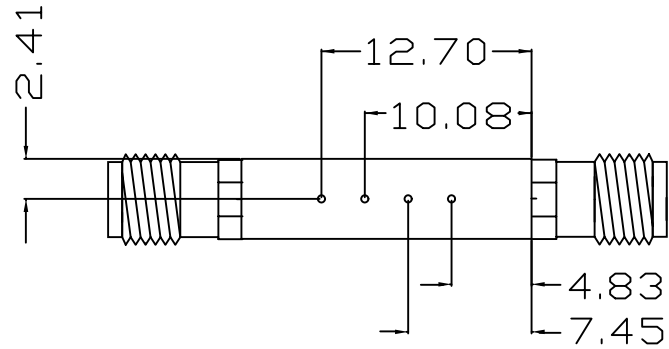

MARKING - BLACK
 GENERAL TOLERANCE : ± 0.3 mm

NEXT ASSEMBLY		FINISH	GOLD		NAME	DATE	
		PLATING PER			DRAWN	M.D 27/11/94	
		PAINTING PER			ENG APP'D	A.C 27/11/94	
		MATERIAL	AL-6061-T6		QA. APP'D	M.C 27/11/94	
		SUREFACE FINISH					
		GENERAL TOLERANCES				TITLE SPDT REF SWITCH P.C: 601 (AVANTEK)	
DIM	MM/INCH	.X $\pm .10 / .010$ "					
SCALE		.XX $\pm .05 / .005$ "					
		.XXX $\pm .025 / .002$ "				DRAWING NO.	R-27
		EYAL MICROWAVE INDUSTRY				REV.	